

# TX2LR / TX2PT Series Chisel Scalers

## Heavy Hitter Long Reach Scaler & Push Throttle Heavy Hitter Chisel Scaler

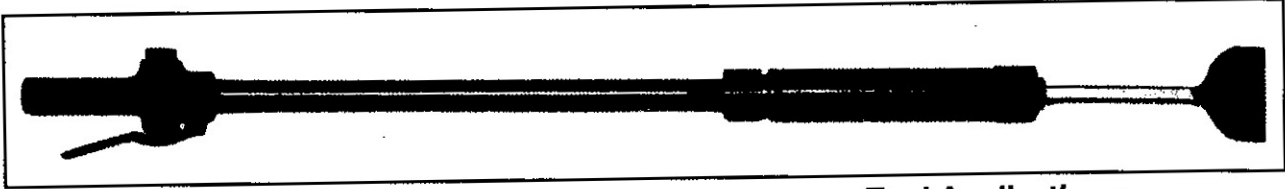

**2**

- ★ Proudly made in the U.S.A.
- ★ World class value pricing.
- ★ Parts availability virtually guaranteed.
- ★ Quality equal to or better than competitively made scalers.
- ★ Texas Pneumatic parts are more reasonably priced for lower cost maintenance during the life of the tool.

### Tool Applications: Long Reach Scaler

- Tile and non-skid removal
- Grease and paint removal
- Glue and resin removal
- Barnacle and heavy scale removal

### Push Throttle Scaler

- For use in foundry casting cleaning

*This tool hits twice as hard as a regular scaler. It has a 2" stroke on the piston compared to 1-1/4" on the TX1B.*

SPECIFICATIONS:								
MODEL #	STROKE	LENGTH	WEIGHT	BORE	INLET	MIN. HOSE SIZE	CFM CONS.	BPM
TX2LRCS	2"	48" or 60"	14 lbs.	15/16"	1/2"	1/2"	10-12	3400
TX2PTCS	2"	17-1/2" with chisel	6 lbs.	15/16"	1/4"	3/8"	10-12	3400

**This tool hits twice as hard as a regular scaler. It has a 2" stroke on the piston compared to 1-1/4" on the TX1B.**

### Chisels Available for TX2:

MODEL #	DESCRIPTION
TX-20000	3" W X 9" L FLAT CHISEL (TX2LR)
TX-20029	3/4" W X 5-1/2" L FLAT CHISEL (TX2LR)
TX-20030	1-3/8" W X 5" L FLAT CHISEL (TX2LR)
TX-20031	1-3/8" W X 5" L SPOON CHISEL (TX2LR)

### Blade & Holder: NEW WIDE SCRAPER BLADES

MODEL #	DESCRIPTION	
TX-20100	Blade Holder only	See Schematic Next 2 Pages
TX-20104	4" Width with Holder	
TX-20108	8" Width with Holder	
TX-20112	12" Width with Holder	

# TX2LR / TX2PT Series

## TX2LR / TX2PT Chisel Scalers Heavy Hitter Long Reach Scalers

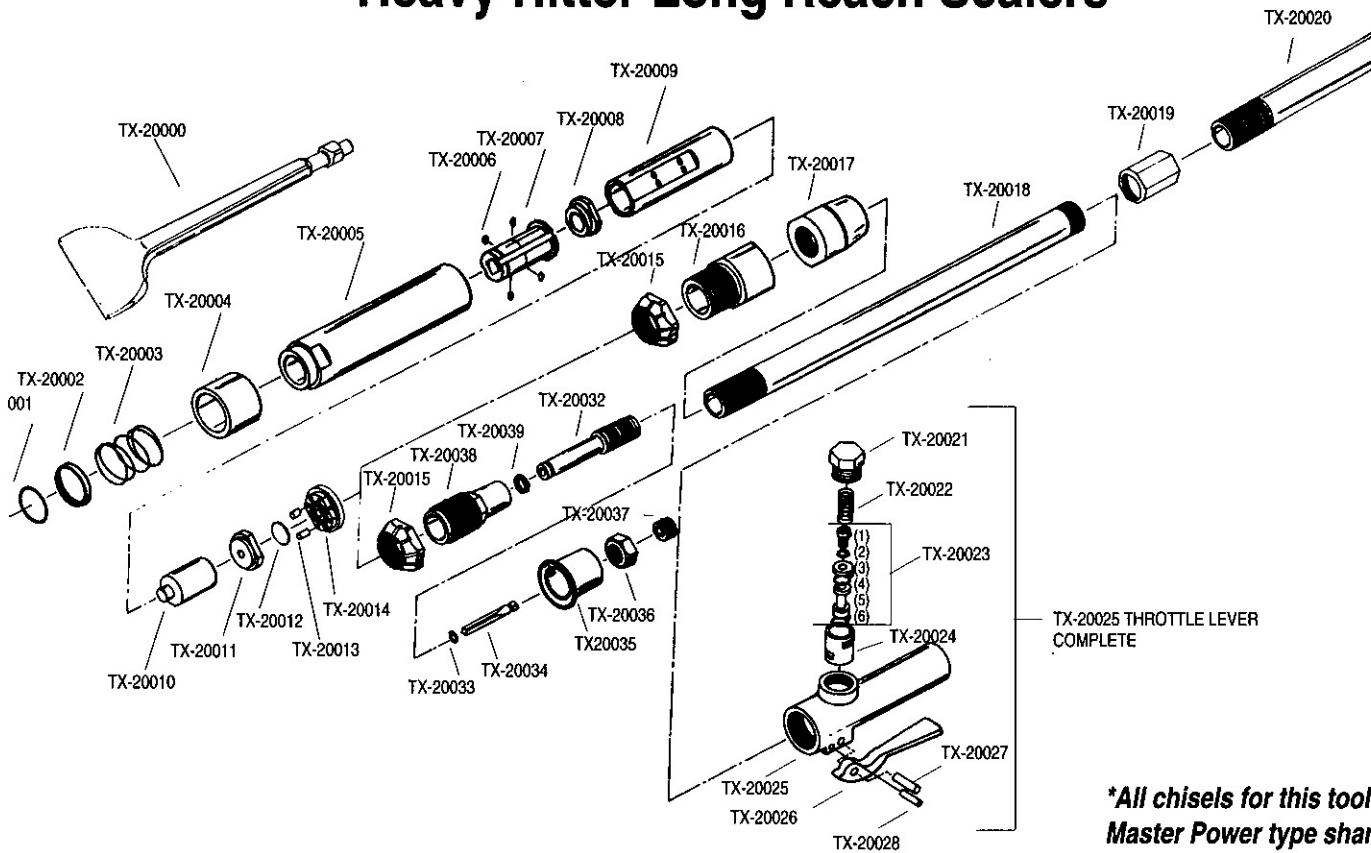

**2**

### Part List

Part #	Description
TX-20000	3" WIDE MS SHANK 9" LONG CHISEL
TX-20001	RETAINER CLIP
TX-20002	RETAINER WASHER
TX-20003	RETAINER SPRING
TX-20004	RETAINER
TX-20005	BARREL
TX-20006	5/16" STEEL BALLS (4)
TX-20007	TOOL NOSE
TX-20008	SLEEVE NOSE
TX-20009	LINER
TX-20010	PISTON
TX-20011	LOWER VALVE BLOCK
TX-20012	FLUTTER VALVE
TX-20013	DOWEL PINS 1/8 X 7/16" (2)
TX-20014	UPPER VALVE BLOCK
TX-20015	BACKHEAD LOCK RING
TX-20016	BACKHEAD BLOCK
TX-20017	BACKHEAD LOCKING PIPE NUT
TX-20018	2' PIPE EXTENSION
TX-20019	EXTENSION COUPLING
TX-20020	1' PIPE EXTENSION
TX-20021	THROTTLE VALVE CAP
TX-20022	THROTTLE VALVE SPRING
TX-20023	THROTTLE VALVE ASSEMBLY
	CONSISTING OF:
	(1) SCREW
	(2) LOCKWASHER
	(3) TV CAP

	(4) "O" RING FACE
	(5) TV BODY
	(6) "O" RING FOR STEM
TX-20024	THROTTLE VALVE BUSHING
TX-20025	LIVE HANDLE COMPLETE
TX-20026	THROTTLE LEVER
TX-20027	STOP PIN
TX-20028	LEVER PIN
	<b>PUSH TYPE THROTTLE ASSEMBLY</b>
TX-20015	BACKHEAD LOCK RING
TX-20038	PUSH TYPE BACKHEAD
TX-20039	C CLIP RETAINER
TX-20032	THROTTLE VALVE CASING
TX-20033	"O" RING
TX-20034	THROTTLE VALVE
TX-20035	CONTROL VALVE HANDLE
TX-20036	LOCKING NUT
TX-20037	VALVE RETAINER

### Chisels Available

MODEL #	DESCRIPTION
TX-20000	3" W X 9" L FLAT CHISEL (TX2LR)
TX-20029	3/4" W X 5-1/2" L FLAT CHISEL (TX2LR)
TX-20030	1-3/8" W X 5" L FLAT CHISEL (TX2LR)
TX-20031	1-3/8" W X 5" L SPOON CHISEL (TX2LR)

### TX2LR-RK Repair Kit

**TX-20001**  
**TX-20002**  
**TX-20003**  
**TX-20006**  
**TX-20010**  
**TX-20012**  
**TX-20013**  
**TX-20022**  
**TX-20023**  
**TX-20028**